

↘ DIN 46397

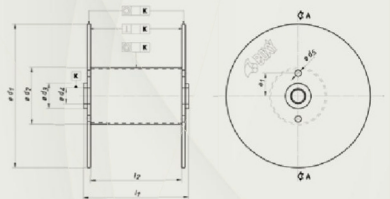

d_1	d_2	d_3	d_4	d_5 hole/pin	e_1	t_5	l_1	l_2
100	56		50			1	80	60
125	71		63				95	75
160	90		80				118	95
200	112	-	100	-	-	1.6	150	118
	125							
	140							
224	125						170	140
	140							
	160							
250	140						190	160
	160							
	180							
315	180						236	200
	200							
	224							
355	200	160	127	16		2	212	180
	224							
	250							
400	224						236	200
	250							
	280							
450	250						265	224
	280							
	315							

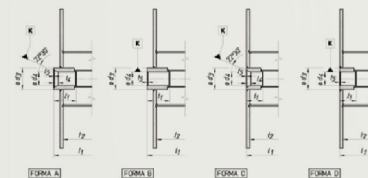

d_1	d_2	d_3	d_4	d_5 hole/pin	e_1	t_5	l_1	l_2
500	280						300	250
	315						375	315
	355						335	280
560	315	160	127	28	100	2	425	355
	355						375	315
	400						375	315
630	355						475	400
	400						425	355
	450						425	355
710	400						530	450
	450						475	400
	500						475	400
800	450	300	250	40	170	2.5	600	500
	500						750	630
	560						950	800
1000	560						950	800
	630							
	710							
1250	710			50	250		950	800
	800							
	900							